



PetroProof SP15/20

Hose Pumps for Hydrocarbons

Features and Benefits

- *Highly suitable for:*
 - hydrocarbons, oils, solvents, acids and bases
 - shear sensitive products
 - viscous products
 - abrasive and high density products
 - vacuum situations
- *Most suitable for handling shear sensitive products*
- *Accurate (+1%) dosing (metering) capabilities*
- *Smooth liquid passage without valves, dead corners or glands*
- *The material to be pumped does not contact mechanical parts or seals*
- *Easy maintenance, low cost, short down time*
- *Only one wearing part: the hose*
- *Easily and completely cleanable*
- *Easily adjustable and reversible rotation*
- *No metal contact or valves*
- *Safe for use in explosive environments*
- *No internal back flow (slip)*
- *Self priming to 95% vacuum*
- *One year comprehensive warranty*

Performance Characteristics

PetroProof hose pump	15/20
Inner diameter pump hose [mm]	20
Capacity [gal/min]	0.63-2.38
Number of revolutions [rpm]	20-75
Starting torque [in-lbs]	2650
Running torque @72.5psi [in-lbs]	345

Standard configuration is geared at 49.2 rpm with 2 Hp motor.
 Consult Watson-Marlow Bredel for alternative configurations.

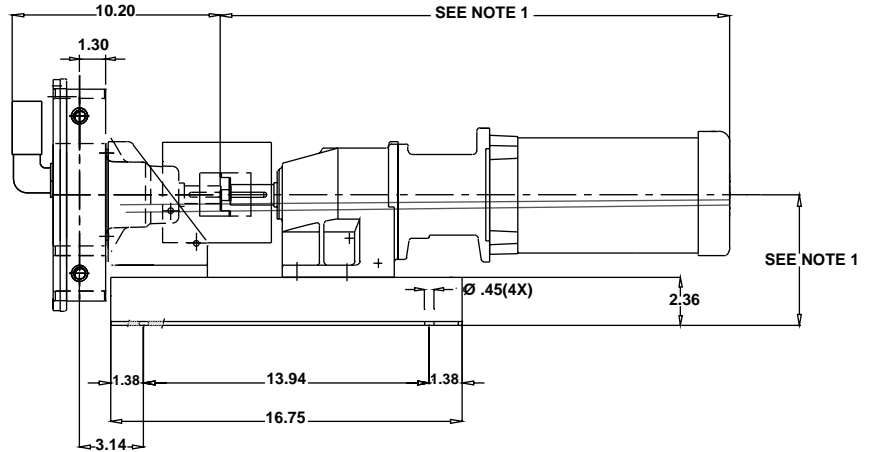
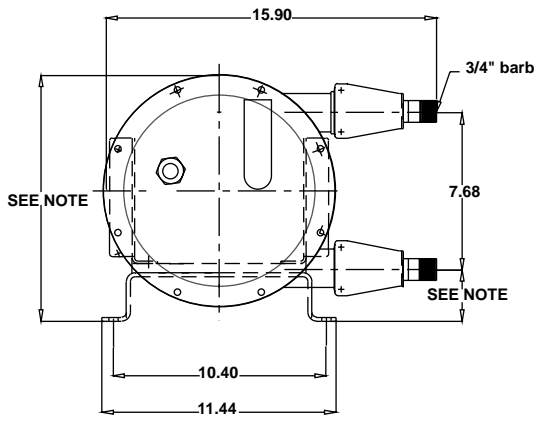

Notes:

1. Dimension is dependent on selection of gearbox and/or motor
2. All Dimensions in inches

PetroProof SP15/20 Hose Pumps for Hydrocarbons

Technical Specifications

Displacement: SP15/20 0.032 gal/rev
Supply: 115/230 VAC 1-phase or
 230/460 or 575 VAC 3-phase
Operating Speeds: up to 75 rpm
Fluid Temperature Range*: 14° to 104°F
Ambient Temperature Range:** -4° to 113°F
Hose Lubricant Required: 0.13 gallons
Flow Range: up to 2.38 gpm
Discharge Pressure: up to 72.5 psi
Suction Pressure: 28 ft. lift to 30 psi
Available Hose Materials: PetroProof
Available Insert Materials: 316SS
Fittings: 3/4" SS hose barb

Materials of Construction

Pumphead: Cast iron
Rotor/Shoes: Cast iron
Cover: Cast iron
Flanges and Flange Brackets: Galvanized steel
Frame: 304SS
Hardware: Galvanized steel or 304SS
Shaft: Alloy steel
Seals: NBR
Coupling Guard: 304SS
Pumphead Weight: 43 lbs
Estimated Assembly Weight: 175 lbs

*Consult Watson-Marlow Bredel for lower or higher temperature operation

**Allowable ambient temperature is based on pump capabilities and may be further limited by gearmotor ambient capabilities.

The information contained in this document is believed to be correct, but Watson-Marlow Bredel Pumps accepts no liability for any errors it contains, and reserves the right to alter specifications without notice.

Watson-Marlow Bredel Pumps

37 UPTON TECHNOLOGY PARK, WILMINGTON, MA 01887-1018
 TEL: 800-282-8823, 978-658-6168 / FAX: 978-658-0041
<http://www.watson-marlow.com>