

# Operating Instructions



**Sanitary Pump**

**Type** *F 560 GS..-50/21*  
*F 560 GS..-54/26*  
*F 560 S.. - 50/21*  
*F 560 S.. - 54/26*



FLUX PUMPS CORPORATION

4330 Commerce Circle  
Atlanta, Georgia 30336  
phone: 404-691-6010  
fax: 404-691-6314  
toll free: 800-FOR-FLUX  
[www.flux-pumps.com](http://www.flux-pumps.com)

## Safety Instructions



- Pumps are not approved to transfer flammable liquids (Zone 0).
- Only use the pump for its intended purpose.
- Install the pump in a way which ensures that it cannot fall into the container.
- Only use the pump with a suitable hose.
- Ensure that the hose is securely fixed to the hosetail.
- Regularly check the hose and connections to ensure safe operation.
- The pump should not be immersed deeper into the liquid than the outlet connection.



- Comply with all relevant safety instructions. Wear appropriate protective clothing (Face shield, protective gloves etc. ).

- Comply with the operating instructions of the motor. ( Some three-phase motors have their safety instructions contained with the terminal box ).
- Never operate pump dry.
- The pump should not be exposed to the weather.
- Clean after each operation.
- Never store the motor in areas in which corrosive vapours exist.



### Pumps F 560 GS ... and F 560 S ...

- Never operate against a closed outlet.
- If the pump is operated against a closed outlet, a by-pass (pressure relief) valve must be used.

## For use in hazardous locations



Only use motors which are approved for use in hazardous locations (Zone 1).

Motors to be used with the pump F 560 GS ... :

- F 410 Ex Commutator motor
- F 450 Ex Commutator motor
- F 460 Ex Commutator motor
- F 416 Ex Compressed air motor ( approval not necessary )
- F 416-1 Ex Compressed air motor ( approval not necessary )

Motors to be used with the pump F 560 S ... :

- Explosion-proof three-phase motors  
0,75 to 1,1 kW, 700 to 930 rpm
- Compressed air motors FPM 4, FPM 6, FPM 8 ( approval not necessary ).



Observe the Test Certificate or the Certificate of Conformity.

- The explosion-proof motor has to be outside the container.
- Only use electrically conductive hoses (see TRbF 131 part 2). This will provide a conductive path for the pump, hoses and fittings.
- Only use an explosion-proof plug or an explosion-proof cable terminal box when making connections to the motor.
- If the electrical socket or the terminal box is positively located outside of the hazardous area, connection to explosion-proof equipment must not be undertaken.



The installation and operations must comply with the relevant Health & Safety Regulations.

## Pump F 560 GS ...

Available drive motors :

- **Commutator motors** F 408, F 448, F 417, F 457, F 458, F 417 EL, F 457 EL, F 410 Ex, F 450 Ex, F 460 Ex.
- **Compressed air motors** F 416 Ex, F 416-1 Ex.

- Make sure that the supply voltage corresponds to the voltage indicated on the name plate.  
When using compressed air motors, please do not exceed the maximum operating pressure and use a filter-regulator-lubricator unit.
- Put the motor onto the pump.
- Firmly tighten the union nut by hand.
- Immerse the pump into the liquid and secure it in a vertical position by the use of a compression gland or a container clamp.
- Secure the discharge hose on the container to be filled.
- Before inserting the electrical plug into the socket, ensure that the Start/Stop switch is set to "0" ( Stop ). For compressed air motors, the air isolation valve must be closed.
- Insert the plug or connect the compressed air hose.
- Switch on the motor.
- When using compressed air motors, adjust the speed by the air pressure.

## Pump F 560 S ...

### Available drive motors :

- **Three-phase motors**  
0,75 to 1,1 kW, 700 to 930 rpm
- **Compressed air motors FPM 4, FPM 6, FPM 8**



- Installation and repairs to three-phase motors should only be carried out by suitably qualified personnel.
- Only use three-phase motors with a starter including an overload cut-out.
- Make sure that the supply voltage corresponds to the voltage indicated on the name plate.  
When using compressed air motors, please do not exceed the maximum operating pressure and use a filter-regulator-lubricator unit.
- Check direction of rotation of the motor.  
In case of portable use, check again the direction of rotation.  
(Direction of rotation according to the arrow on the bearing flange).
- Clean bearing flange and motor flange.
- Fit the motor onto the bearing flange and tighten the screws.

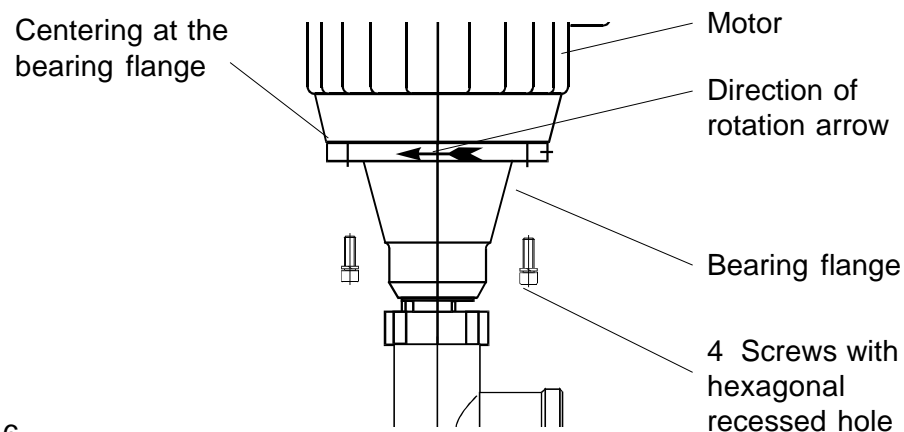

- Immerse the pump into the liquid and secure it in a vertical position by the use of a compression gland or a container clamp.
- Before inserting the electrical plug into the socket, ensure that the Start/Stop switch is set to "0" ( Stop ).For compressed air motors, the air isolation valve must be closed.
- Insert the plug or connect the compressed air hose.
- Switch on the motor.
- When using compressed air motors, adjust the speed by the air pressure.  
Do not exceed the maximum speed of 1000 min<sup>-1</sup>.

## Cleaning after each operation

### Clean the pump by flushing an appropriate cleaning agent.

- Pump and hose must be resistant to the cleaning agent.
- The pump should not be immersed into the cleaning agent higher than the outlet connection.
- Do not use flammable liquids to clean the pump or motor.
- After each operation with sticky or self hardening liquids, the pumps should be flushed with a suitable cleaning agent.  
The pump should then be dismantled and the mechanical seal carefully cleaned.
- After cleaning a few drops of lubricant should be put on the stator and on the eccentric worm.  
Afterwards run the motor briefly.

## Storage

- Unplug the pump or disconnect the compressed air hose.
- Use a wall bracket to store the pump in a vertical position.

# Dismantling / Re-assembly

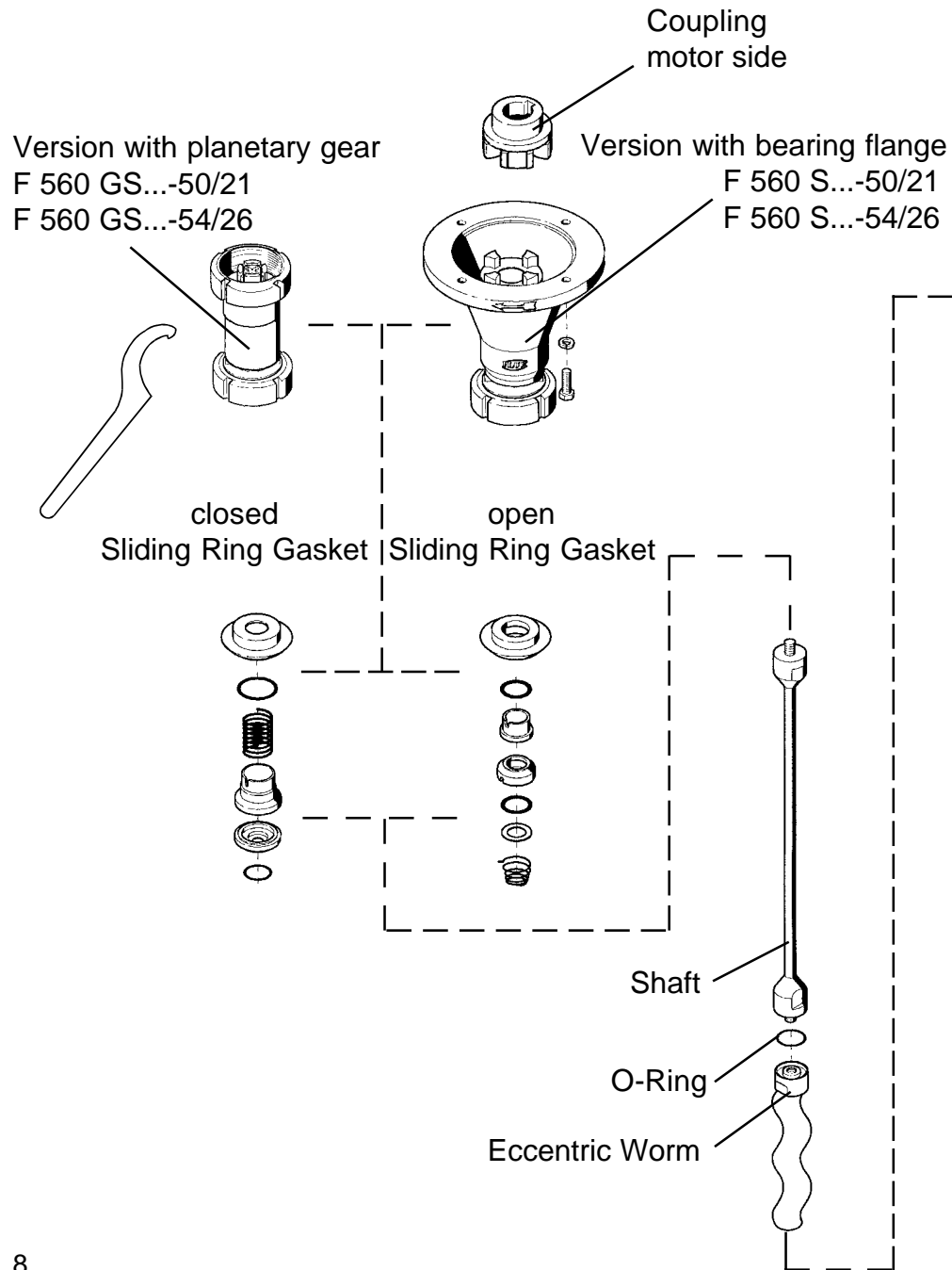

Outer Tube:			
F 560 GS3A-...	F 560 S3A-...	Clamp 2"	ground and polished
F 560 GS1-...	F 560 S1-...	Rd 58 x 1/6	electrolytically polished
F 560 GS2-...	F 560 S2-...	G 1 1/2 A	electrolytically polished
F 560 GS3-...	F 560 S3-...	Clamp 2"	electrolytically polished

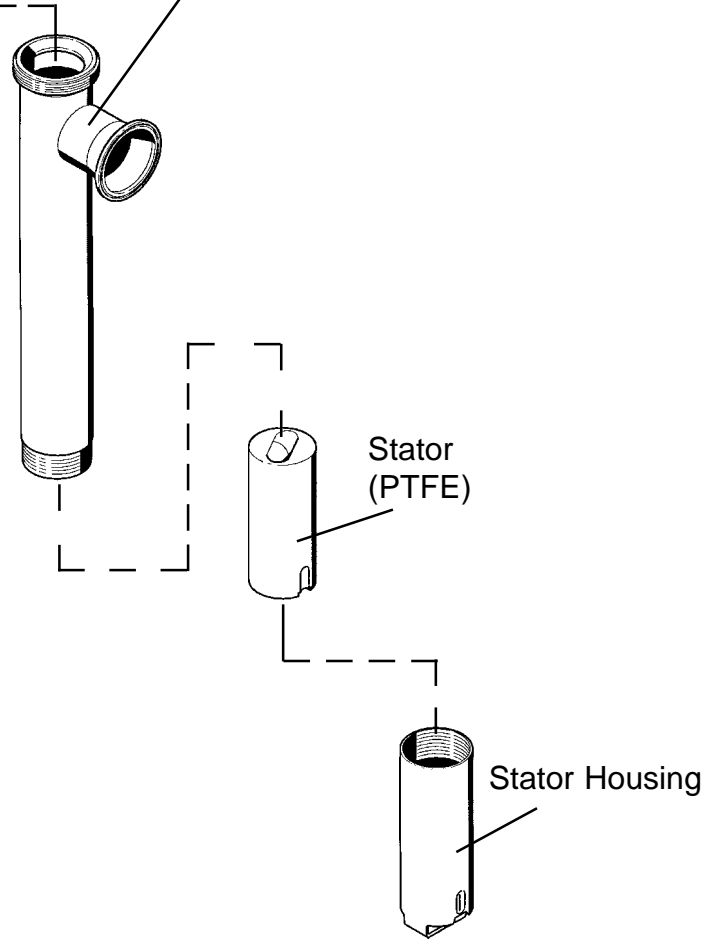

## Dismantling of the closed Sliding Ring Gasket (SLRG)



- Make sure that the sealing and sliding faces on the SLRG will not be damaged.
- Make sure that the sealing faces on outer tube and centering disc will not be damaged.
- Do not use any tools to dismantle the SLRG to avoid any damage.

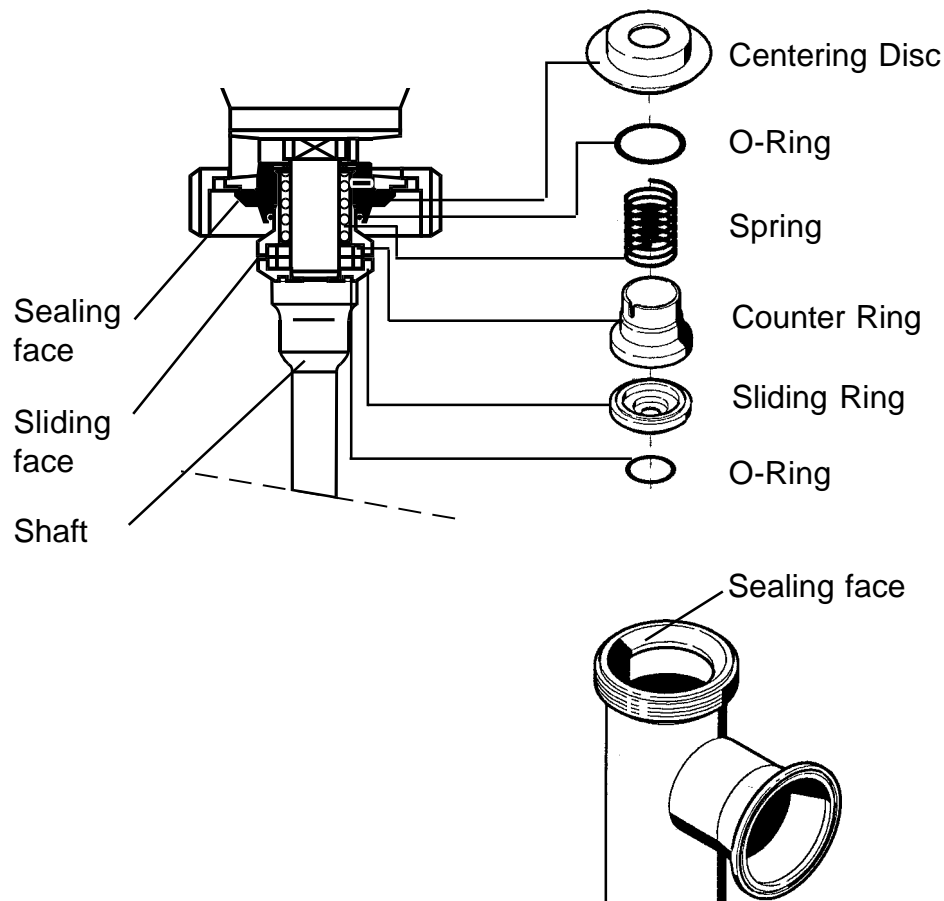

## Dismantling of the open Sliding Ring Gasket (SLRG)



- Make sure tht the sealing and sliding faces on the SLRG will not be damaged.
- Make sure that the sealing faces on outer tube and centering disc will not be damaged.
- Do not use any tools to dismantle the SLRG to avoid any damage.

